



**combi wear parts**  
move the earth

PRODUCT RANGE

**PROCLASS**<sup>®</sup>



# PROCLAWS

PRODUCT RANGE OVERVIEW

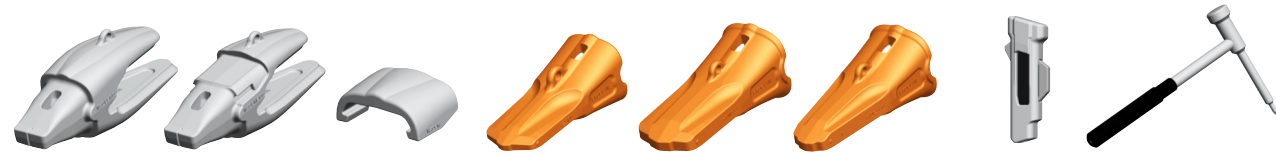

SiZe	adaPter		wear caP	teeth			lock	tool
	Be	Bme	cm	gPe	ae	Pe	l	t
w25	<b>725011</b>			<b>725100</b>	<b>725110</b>		<b>725301</b>	<b>700700</b>
	70 mm			413 mm	425 mm			
	54,2 kg			28,1 kg	33,8 kg		1,2 kg	
w30	<b>730010</b>	<b>730012</b>	<b>730501</b>		<b>730110</b>	<b>730120</b>	<b>730301</b>	<b>700700</b>
	90 mm	90 mm			469 mm	481 mm		
	82,8 kg	76,4 kg	7,7 kg		48,9 kg	45,4 kg	1,3 kg	
w40	<b>740010</b>	<b>740012</b>	<b>740501</b>		<b>740110</b>	<b>740120</b>	<b>740301</b>	<b>700700</b>
	100 mm	100 mm			521 mm	534 mm		
	124,5 kg	115,5 kg	11,6 kg		65,7 kg	60,9 kg	1,8 kg	



liP THICKNESS	liP ShroudS					locking PartS		
	CENTER	LEFT	RIGHT	RAIL	PROTECTOR	Sl	waSher	Screw
70mm								
90mm	<b>700404</b> 0° / 320 mm 81,1 kg	<b>700405</b> 15° / 320 mm 81,2 kg	<b>700406</b> 15° / 320 mm 81,2 kg	<b>700413</b> 3,4 kg	<b>700424</b> 6,7 kg	<b>700303</b>	<b>700330</b> M27	<b>700350</b> M27 x 260
100mm								

Side Shroud	Plate THICKNESS	50 mm	65 mm	70 mm
	SSm			<b>700601</b> 564 mm 39,5 kg
Pin ring			<b>700320</b> <b>700330</b>	

adaPter		wear caP	lock
<b>Be</b> Standard bottom leg adapter. Low profile design, improved flow of material in and out of bucket.	<b>Bme</b> Bottom leg adapter with a mechanical wear cap. The top of the adapter is well protected against excess wear.	<b>cm</b> Mechanical Wear Cap protects the adapter top side in high abrasion and impact applications.	<b>l</b> Standard lock provides easy and secure tooth replacement. The vulcanized rubber core provides a strong and tight fit.

teeth			tool
<b>ae</b> Abrasion tooth for highly abrasive soils and rocks such as granite, basalt and sandstone. The design provides maximal wear material which maintained good penetration.	<b>Pe</b> Penetration tooth with added body mass and narrow tip combines penetration with impact and abrasion resistance.	<b>gPe</b> Standard tooth with slim design for optimal penetration and durability in general purpose applications.	<b>t</b> Tool for mounting and dismounting the locking device. Simplifies the change of teeth and is recommended for safety reasons.

liP ShroudS			
<b>mSc</b> Mechanical lip shroud center For straight edges and for use in combination with MSL & MSR on spade nose buckets. Provides full lip protection between adapters in abrasive applications.	<b>mSl</b> Mechanical Lip Shroud left* 15° angel for delta and spade nose buckets.  * Left from excavating direction.	<b>mSr</b> Mechanical Lip Shroud right* 15° angel for delta and spade nose buckets.  * Right from excavating direction.	<b>mSP</b> Mechanical Shroud Protector designed to protect the locking device and the backside of the shrouds.

rail	locking PartS	Side ShroudS	Pin and ring
<b>wSr</b> Welded on Shroud Rail Holds the Lip Shrouds in secure position.	Shroud lock, Srew and washer Self tightening bolt, lock and washer for the mechanical shroud.	<b>SSm</b> Mechanical Side Shroud is used to protect the bucket side plates and fastened with Pin and Ring.	<b>Pin and ring</b> Locking pin and ring for the side shroud.

Applications table			
Based on DIN 18300 ground classification			
Ground classification	Description of ground conditions	Working conditions	Application
Class 1 Top soil without stones	Top layer of soil.	Very little wear. Very little penetration resistance. No impact resistance.	GP
Class 2 Wet ground	Sludge, mud, peat.	Little wear. Very little penetration resistance. No impact resistance.	GP
Class 3 Light ground	Sand, fine gravel, sandy soil. Stone size up to approx. 2,4 inches.	Moderate wear. Little penetration resistance. No impact resistance.	GP
Class 4 Moderately heavy ground	Very stony ground, gravel, stones. Stone size above 2,4 inches.	Considerable wear. Some penetration resistance. Moderate impact resistance.	GP / HD
Class 5 Dense, moderately heavy ground	Till, rigid clay, sand-clay mix, moraine, marl.	Considerable wear. Moderate penetration resistance. Little impact resistance, some break through resistance.	HD
Class 6 Dense heavy ground	Hard marl and clay, hard sandy ground, hard stony soil. Stone size up to approx. 8 inches.	Considerable wear. Considerable penetration resistance. Considerable impact and break through resistance.	HD
Class 7 Lighter rock	Loose rock, crumbled rock, slate. Very hard ground with stones, approx. 8 inches or bigger.	Usually considerable wear. Considerable penetration resistance. Considerable impact and break through resistance.	XHD
Class 8 Heavy rock	Blasted rock, size over 3.53 ft <sup>3</sup> .	Very significant wear. Considerable penetration resistance. Very significant impact and break through resistance.	XHD

For further information on welding, assembly and maintenance, see welding and assembly instructions.  
For further information on dimensions, see specifications.

#### Breakout force diagram - Backhoe

<b>hd/Xhd</b> class 6-8	<b>w40</b>	623 kN
	<b>w30</b>	506 kN
	<b>w25</b>	412 kN
<b>gP/hd</b> class 1-5	<b>w40</b>	779 kN
	<b>w30</b>	633 kN
	<b>w25</b>	515 kN

#### Breakout force diagram - Face shovel

<b>hd/Xhd</b> class 6-8	<b>w40</b>	779 kN
	<b>w30</b>	633 kN
	<b>w25</b>	515 kN
<b>gP/hd</b> class 1-5	<b>w40</b>	973 kN
	<b>w30</b>	791 kN
	<b>w25</b>	643 kN



**combi wear parts**  
move the earth



**stury** schweisst  
konstruiert  
fertigt

Riedgrabenstrasse 13, 8153 Rümlang  
Tel. 044 817 19 39 - [www.sturyag.ch](http://www.sturyag.ch) - [info@sturyag.ch](mailto:info@sturyag.ch)